

SYSTEM OVERVIEW

EnviroPure EPW Systems are self-contained, continual feed, organic food waste elimination systems that convert food waste into water. The technology uses a combination of mechanical processing, heat, oxygen and all-natural additives to accelerate the natural aerobic decomposition process. Organic waste is quickly reduced to a gray water effluent that can be safely disposed of into existing municipal waste water systems. EPW systems handle virtually any kind of food waste including vegetables, fruits, meat, fish and poultry, dairy products, bones, shells and pits, with complete decomposition typically occurring within 24 hours!

STANDARD FEATURES

- **UL® U.S. & Canadian Certified**
- Simple one-button on/off, fully automated “feed it and forget it” operation
- Automatic on/off interlock door safety switch
- High quality, heavy duty Gould, Emerson & Vaughan pumps and motors provide quiet operation and superior performance
- Front mounted controls and display panel provide quick and easy operation, troubleshooting, monitoring and reporting of system function
- Commercial grade stainless steel enclosure
- 10 different sizes to fit any size foodservice operation (custom models up to 3 tons/day capacity available)
- Same day installation. Standard 208/220V power requirements, cold water and waste water line hookup using standard PVC/copper fittings

- All natural, non-toxic, biodegradable EPW-BioMix additive catalyzes and accelerates naturally occurring biological decomposition processes
- Continual oxygenation of decomposition tank ensures fully aerobic decomposition process resulting in water and carbon dioxide bi-products
- Complete elimination of all solid food waste with absolutely NO odors, NO sludge build-up and NO system cleanout required
- Gray water effluent bi-product meets standards for safe disposal into municipal waste water sewer systems

QUALITY MEASURED	MUNICIPAL LIMITS	ENVIROPURE
Biological Oxygen Demand (BOD)	300 mg / L	< 30 mg / L
Fats, Oils & Grease (FOGs)	150 mg / L	< 10 mg / L
Total Suspended Solids (TSS)	300 mg / L	< 30 mg / L

* Always confirm municipal waste water limits and requirements in your area

- System does *not* require connection to grease interceptor

OPTIONS & ACCESSORIES

- Remote Food Disposal Grinder System**
Commercial grade stainless steel foodservice food waste disposer integrated into your kitchen prep areas and/or dish line for remote feeding of food waste into system
- Custom Configured Chute / Scrap Table / Trough Feeder Systems**
- Interior / Exterior / Combination Install Configurations Available**
- Cold Weather Exterior Install Package**
Steel frame construction, galvanized siding, insulated enclosure, with heater & blower, feed/drain piping sleeves and electrical heat tape wrap for exterior installations in cold weather climates
- 3 Phase 600V Electrical Connection**
- 10/100 Base-T RJ-45 Network Connection**
Network connection for remote control, monitoring, and notification of system functions, performance and fault states. Front end reporting and monitoring software included. (* Available late 2012)



Distributed by Air Cycle Corporation
2200 Ogden Avenue Suite 100, Lisle, IL 60532
Jim Hattler 800-909-9709 x3824
Jim@aircycle.com

EPW Systems

Hyper-accelerated, on-premises
Food Waste Elimination Systems



EPW FOOD WASTE ELIMINATION SYSTEM

Dimensions shown in inches.

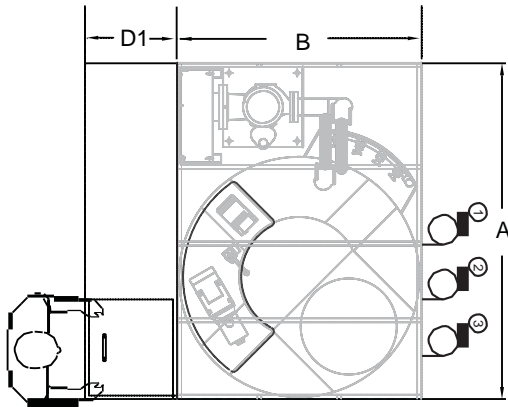

Top View

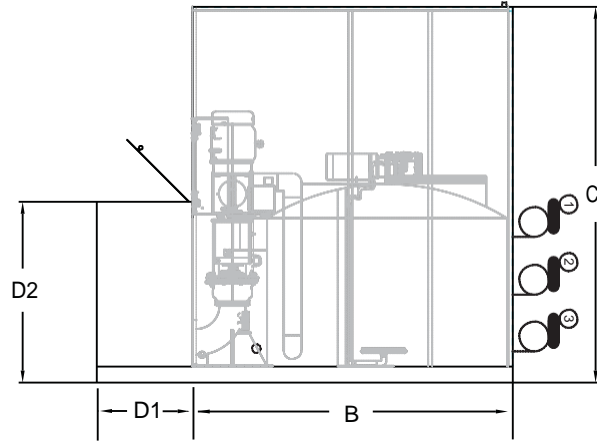

Side View

MODEL	CAPACITY		DIMENSIONS					WEIGHT	CONSUMPTION		
	Lbs lbs/day	Tons t/mth	A in	B in	C in	D1 in	D2 in	Empty lbs	Water US Gal / Hr	Power kWh / Hr	BioMix US Gal / Day
EPW-120(i)	120	1.8	34	42	60	N/A	N/A	900	1.1	0.24	0.04
EPW-240(i)	240	3.7	34	54	83	N/A	N/A	1,000	2.0	0.24	0.08
EPW-480(i)	480	7.3	52	66	75	N/A	N/A	2,200	4.0	0.32	0.16
EPW-720(i)	720	11.0	76	90	78	N/A	N/A	2,500	6.0	0.32	0.24
EPW-1000(i)	1,000	15.2	76	90	93	N/A	N/A	2,600	7.9	0.32	0.34
EPW-1500(i)	1,500	22.8	94	108	93	N/A	N/A	2,700	11.8	0.32	0.50
EPW-2000(i)	2,000	30.4	106	120	102	N/A	N/A	3,000	15.8	0.32	0.67
EPW-720v	720	11.0	76	90	78	24	42	3,000	6.0	0.32	0.24
EPW-1000v	1,000	15.2	76	90	93	24	42	3,100	7.9	0.32	0.34
EPW-1500v	1,500	22.8	94	108	93	24	60	3,200	11.8	0.32	0.50
EPW-2000v	2,000	30.4	106	120	102	24	60	3,500	15.8	0.32	0.67

Utilities	
1	Electrical 208-240/60/3; 3 wire plus ground, (See Box). 480/60/3; 3 wire plus ground, (See Box).
2	Cold Water 1/2" supply; cold water connection. Incoming supply pressure must maintain a minimum flow rate of 5.0 US gpm [18.9 litres per minute]. Machine equipped with 3/4" NPT male fitting for input cold water connection.
3	Waste Water Drain Machine equipped with 1 1/2" PVC drain connection. Maximum drain flow 15.0 US gpm [56.8 litres per minute].

Elec. Specs.	Rated Amps	Minimum Supply Ckt Conductor Ampacity	Maximum Overcurrent Protective Device
208/60/1	36	40	40
240/60/1	32	40	40
208/60/3	24	30	30
240/60/3	22	30	30
480/60/3	12	15	15

Warning Plumbing and electrical connections should be made by qualified personnel who will observe all the applicable plumbing, sanitary and safety codes and the National Electrical Code.

Note: Electrical supply service must be a 3-wire plus ground for connection shown.

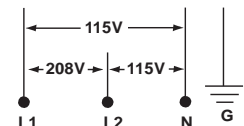

Due to an ongoing value analysis program at EnviroPure, specifications contained in this catalog are subject to change without notice.

Air Cycle Corporation, 2200 Ogden Ave. Suite 100 Lisle, IL 60532, Jim Hattler P: 800-909-9709 x3824 E: Jim@aircycle.com